•

•

†1359-75

Overhead line hardware. Range of mechanical failing loads and hart connection. Dampers and demensions

11359-65

15 1975 . 3464

01.01.77

»'Him

18.09.81 4272

1.

(, . 1).

2.

2.1.

(, . 1).

2.2.

20; 40; 70; 100; 120; 160; 210; 250; 300; 350; 400; 450; 530; 600; 750; 900; 1100; 1200; 1350; 1600; 1800; 2400; 2700; 3600.

3.

3.1.

2731-82,

2735-78

2730-78.

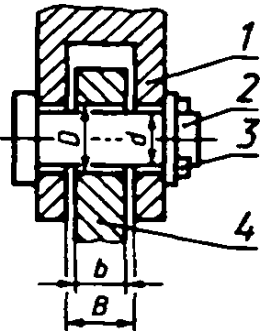
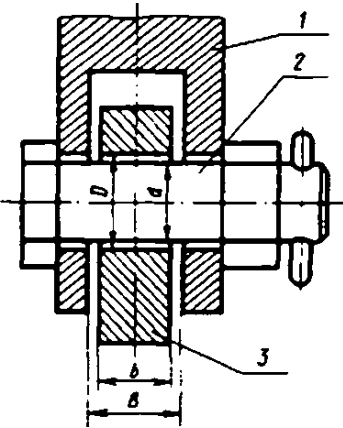

1 — ; 2 — ; 3 —

1 — ; 2 — ; 3 — ; 4 —

. 1

* (1998 .)

1985 . (1, 2, 8-83, 3-86)

1983 .,

© ©

. 1975 . 1999

. (),	B MM		* . . .	
	$\angle - b$			
20(2)	10	+0.9	15	+1.3'
40(4)	14	— .	17	+0.2
70(7)	16			
100(10)	18		19	
120(12)	22	+0.9;	23	+1.5;
160(16)	25	-1.3	26	+0.2
200(21)	28		29	
250(25)	32		34	
300(30)	36		38	
350(35)	38	+0.9;	40	
400(40)	40	-1.6	42	+1.6
450(45)	40		42	
530(53)	42		44	
600(60)	45		47	
750(75)	50		52	
900(90)	56		58	
1100(110)	60	+0.9;	62	+1.9
1200(120)	65	-1.9	67	
1350(135)	70		72	
1600(160)	75		77	
1800(180)	80		83	
2400(240)	95	-2.2	98	+2.2
2700(270)	108		111	
3600(360)	125	-2.5	128	+2.5

(, . 1, 2).

3.2.

20 40
380 (38 / ²).

3.3.

40
500 (50 / ²).

3.2. 3.3. (, . 1).

4.

4.1.

. 2.2

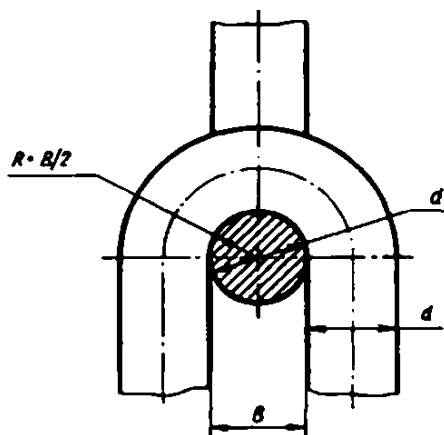

. 2

. () . ^{>}	<i>d</i>			
20(2)	8	9	11	12.5
40(4)	10	12	15	16.5
70 (7)	14	15	17	18.5
100(10)	16	18	19	21.5
120(12)	18	20	23	24.5
160 (16)	20	22	23	27.5
210 (21)	24	26	28	30.5
250 (25)	26	28	29	36.0
300 (30)	28	34	31	40.0
350 (35)	32	38	35	42.0
400 (40)	34	40	37	44.0
450 (45)	34	40	37	44.0
530 (53)	36	42	39	46.0
600(60)	38	44	41	48.5
750 (75)	40	46	43	54.0
900 (90)	48	52	51	60.0
1100(110)	53	58	56	63.5
1200(120)	56	60	59	68.5
1350 (135)	60	66	63	72.0
1600(160)	65	70	68	78.5
1800 (180)	70	75	73	90.0
2400 (240)	80	85	83	99.0
2700 (270)	85	90	88	112.0
3600 (360)	95	100	98	130,0

4.2.

380 (38 / ²).

4, 4.1, 4.2. (, . 1).

. 021007 10.08.95.

- . . 0,40.

19.01.99.

124 .

1866.

04.02.99.

. 85

0.47

. 107076,

.. 14

— . "

",

.. 6

N9 080102