

16044.70*

Solderable fittings for tube connections on internal cone.
Construction and dimensions

839

5 1970 .
01.01.71

1.

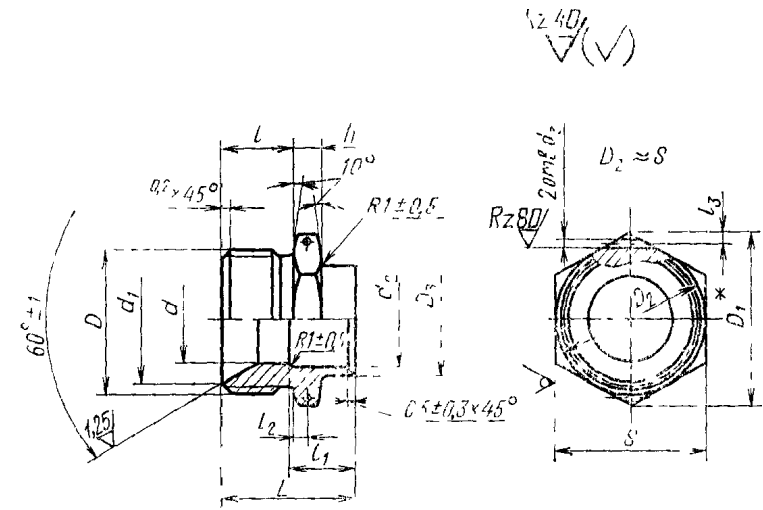

* Размеры для справок.

(1987) 5 1,
1980 . (3—81).

				*					1						h	
	d	di			D		D ₂	S								100
				+0,12 -0,06					0,4			10,2		±0,4	0,2	
6	4	,	6		14 1.5	9,6	8,5	17								1,53
8	6	13,0	8		16 1.5		11,0			9		2,5		24	5	1,97
10	8	15,0	10		Ml 8X1,5	21,9	13,0	19	13							2,34
12	10	17,0	12		Mi 1.5	25,4	15,0	22			rhO ₁ 2					2,87
14	12	19,0	14		22 1.5	27,7	17,0	24		11				26		3,08
15	14	21,0	16	1,	24 1 5	31,2	19,0	27					2,0			3,57
13	16	24,0	18		27 X1.5	34,0	21,0	30	15	13		3,0		28	6	4,52
20	18	27,0	20		30 1.5	36,9	23,0	32								4,92
22	20		22				25,0									4,97
24	22	29,0	24		1.5	41,6	27,0	36	16	14				29		5,18
25	23	32,0	25		36 1.5		28,0									6,36
28	26	35,0	28		39 X 1 5	47,3	31,0	41		15		3,5		30	7	7,66
30	28	35,5	30				33,0		17		±0,4					8,53
32	30	38,0	32		M42XU5	51,3	35,0	46								10,00
34	32	41,0	34		M45XU		37,0									12,42
36	34		36	2,0			39,0			17		4,0	2,5	32	8	13,50
38	36	44,0	38		48 X1 >5	57,7	41,0	50								15,10

(
2. : 25 12 18 9 (18 9).
3. — 16078—70.

25:

16—023 16044—70

12 18 9 :

16—012 16044—70

•

16—023 16044—70

16_012 16044—70