

Thrust rings for tube connections on internal cone.
Construction and dimensions

16048—70

839

f 1970 .
01.01.71

1.

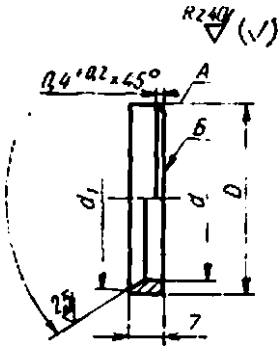

* (1937 .) 1, 2,
1930 „ 1936 .
(3-31. 5—86).

	4	</			100
			. OTK.I.		
18	21,0	24,0	25	55	0,62
20	23.0	27,0	28		0,74
22	25.5	29,0	31		1,09
24	27.0	29.5		0.75	
25	285	31,0	34	50°	0.82
28	315	34,0	37		1,00
30	33,0	35.0			04
32	35,0	38,0	40		1.28
34	37,0	41.0	43		1.60
36	39.0	43,5	46		1.80
38	41,0				1,93

(
2. : , . 1).
3. : 13 11 2 2 (1 12 2).
4. : ==120±10 / 2.
: — 0,05 , — 0,1 .
(
5. , . 2). 16078—70.
18:
18—011 16048—70
:
18—011 16048—70