

16053-70

Union elbows for tube connections on internal cone.
Construction and dimensions

5 1970 .
01.01.71

839

1.

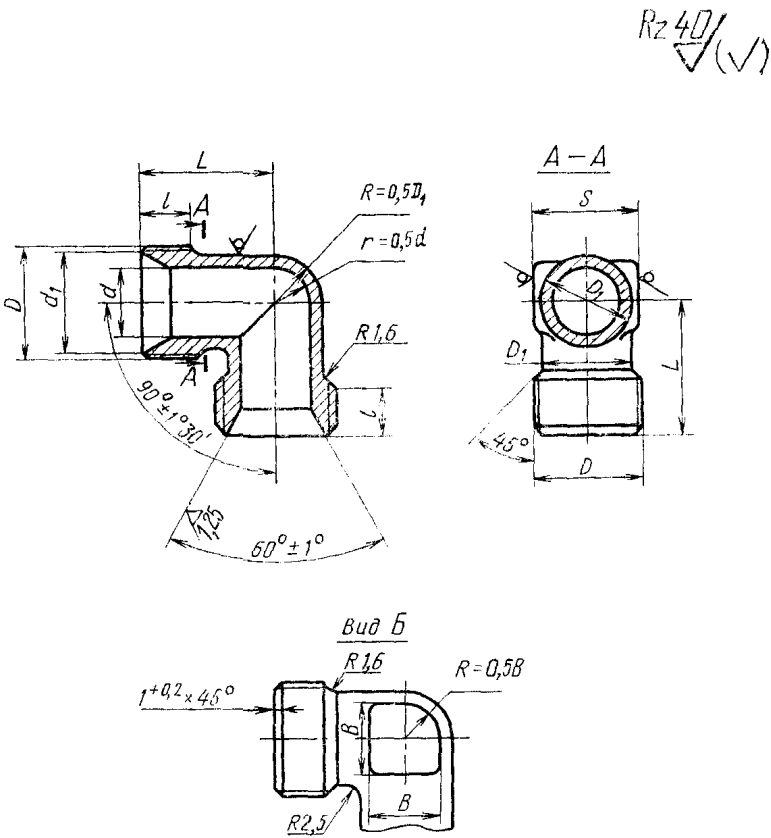

1987 .

	<i>d</i>		<i>d</i> l	<i>D</i>	<i>D</i> t	S	<i>I</i>	<i>L</i>		100
°							±0,4			
6	4		11,0	14 1.5	9	12		21	5	2,56
8	6		13,0	16 1.5		14		22	7	3,45
	8		15,0	8 1.5	13		9		9	4,10
12	10		37,0	20 5	15	17		24	10	5,06
14	12		19,0	22 1,5	17	19		25	13	6,35
16	14		21,0	24 5	19	22		28	15	7,75
18	16		24,0	27 X1,5	22	24		30	17	9,35
20	18		27,0	30 5	24	27			18	11,15
22	20		29,0	1.5	26		12	33	22	13,35
24	22				28	30				15,78
25	23		32,0	36 5	29		36		17,40	
28	26		35,0	39 X1,5	32	32		38	25	22,80
30	28		35,5		34	36			28	26,50
32	30		38,0	42 5	37	41	13	40		29,60
34	32		41,0	45 X1,5	39					33,50
36	34		44,0	48 1.5	41	46		42	30	36,65
38	36				43					41,50

2. : 45, 38 , 12 18 9 (28 9), 13 11 2 2
 (1 12 2).
 3. — 16078—70.

45:

 D_H16

16—022 16053—70
 , 38 :
 16—021 16053-70
 , 12 18 9 :
 16—012 16053—70
 , 13 11 2 2 :
 16—011 16053—70
 , :
 16—022 16053—70
 16—021 16053—70
 16-012 16053—70
 16— 16053—70