

16058—70

Union tees for tube connections on internal cone.
Construction and dimensions

N9 839

5

3976
01.01.71

1.

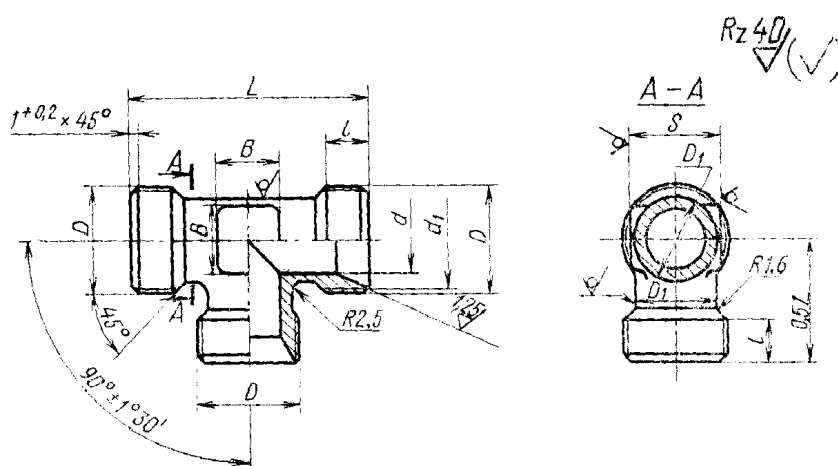

						1	L			
°	d	rfi	D		S	±0,4				100
	4	11,0	14 1.5	9	12		42		5	3,87
8	6	13,0	M16XU5		14		45		7	5,32
10	8	15,0	18 1.5	13		9	40		9	6,90
12	10	17,0	20 1.5	15	17				10	8,77
14	12	19,0	22 1.5	17	19		50		13	10,60
16	14	21,0	24 1,5	19	22		55		15	12,60
18	16	24,0	27 1.5	22	24	11	60		17	14,84
20	18	27,0	30 1.5	24	27			±0,4	18	16,90
22	20	29,0	1/5	26	27	12	68		18	19,23
24	22			28	30				22	21,57
25	23	32,0	36 1,5	29			72			23,06
28	26	35,0	M39X1.5	32	32		75		25	27,00
30	28	35,5		34	36				28	29,60
32	30	38,0	42 1,5	37	41	13	80		30	32,60
34	32	41,0	45 1,5	39						35,56
36	34	44,0	48 1.5	41	46		85	±0,6		38,66
38	36			43					41.83	

2. : 45, 38 , 12 18 9 (18 9), 13 11 2 2
(1 12 2).
3. — 16078—70. D_{tt} 16

45:

	16—022	16058—70
, 38 :		
	16—021	16058—70
, 12 18 9 :		
	16—012	16058—70
, 13 11 2 2 :		
	16—011	16058—70
, :		
	16—022	16058—70
	16—021	16058—70
	16—012	16058—70
	16—	16058—70