

14

16060-70

Reducer-type tees with thread diameter 14 mm on middle fitting
for tube connections on internal cone.
Construction and dimensions

5 1970
01.01.71

839

1.

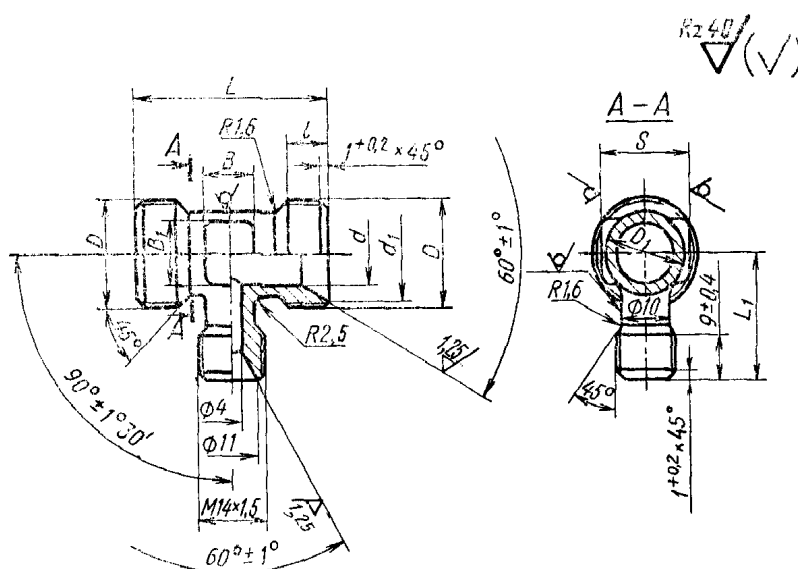

1987

	<i>d</i>	<i>d</i> ,	<i>D</i>	<i>Di</i>	<i>S</i>		<i>L</i>	<i>h</i>		,	100
						±0,4					
12	10	17,0	20 1.5	15	17	9	42	24	10	10	6,47
14	12	19,0	22 5	17	19			25	12	13	7,66
16	14	21,0	24 1.5	19	22	11	45	26		15	8,90
18	16	24,0	27 1,5	22	24			28	17	10,16	
20	18	27,0	30 1>5	24	27	12	48	30	13	18	11,33
22	20	29,0	1.5	26				30	32	14	22
24	22			28	30	13	50				
25	23	32,0	36 1,5	29				13	50	35	16
28	26	35,0	39 X1,5	32	32	38	16				
30	28	35,5		34	36			19,50			
32	30	38,0	42 1,5	37	41	20,77					
34	32	41,0	45 X1,5	39			46	22,10			
36	34	44,0	48 1,5	41	28,50						
38	36			43							

2. : 45, 38 , 12 18 9 (18 9), 13 11 2 2
(1 12 2).
3. — 16078—70.

Du 16

45:

, 38 :	16—022	16060—70
	16—021	16060—70
, 12 18 9 :	16—012	16060—70
	16—011	16060—70
, 13 11 2 2 :	:	
	16—022	16060—70
, 16—	16—021	16060—70
	16—012	16060—70
, 16—	16060—70	
	16060—70	