

Union crosses for tube connections on internal cone.
Construction and dimensions

16065-70

5

1970
01.01.71

839

1.

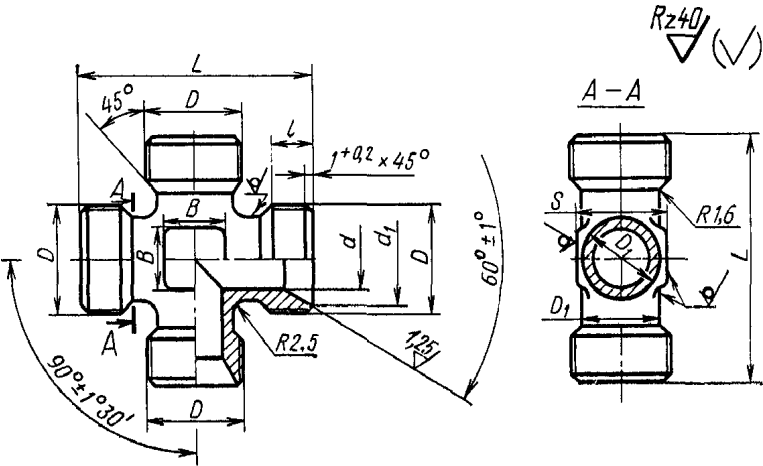

1987

						1	L			
	<i>d</i>	<i>dv</i>	<i>D</i>	<i>D₁</i>		±4				100
6	4	11,0	MI 4X1,5	9	12		42		5	4,48
8	6	13,0	16 1.5		14		45		7	5,55
10	8	15,0	18 1.5	13		9			9	6,83
12	10	17,0	20 1.5	15	17		48		10	8,38
14	12	19,0	22 1.5	17	19		50		13	9,75
16	14	21,0	24 1.5	19	22		55		15	11,55
18	16	24,0	27 5	22	24	11	60	±0,4	17	13,66
20	18	27,0	30 1.5	24	27		62		18	16,40
22	20	29,0	X1,5	26		12	68		22	19,55
24	22			28	30					23,55
25	23	32,0	36 1.5	29			72			25,13
28	26	35,0	M39XU5	32	32		75		25	29,95
30	28	35,5		34	36				28	33,35
32	30	38,0	42 5	37	41	13	78			36,65
34	32	41,0	45 1.5	39			82		30	39,95
36	34	44,0	48 1.5	41	46		85	±0,6		43,40
38	36			43						46,30

2. : 45, 38 , 12 18 9 (18 9), 13 11 2 2
 (1 12 2).
 3. — 16078—70.

, 16

45:

16—022 16065—70
 , 38 :
 16—021 16065—70
 , 12 18 9 :
 16—012 16065—70
 , 13 11 2 2 :
 16—011 16065—70
 , :
 16.022 16065—70
 16.021 16065—70
 16.012 16065—70
 16— 16065—70