



18282—88

Plain bearings. Terms and definitions

18282—88

0023

01.01,89

23.002—78.

1.

. 1.

2.

.

2.1.

. 1

2.2.

2.3.

«

»

2.4. , -

2.5. .

3. .

. 2.3.

4. -

, — .

1

1. Plain bearing | , -

2. - , -

Steadily loaded bearing

3. ,

Dynamically loaded plain bearing

4. , -

Plain journal bearing Journal bearing

5. - , -

Plain thrust bearing Thrust bearing

6. - , ,

Thrust journal bearing

7. - , -

Hydrodynamic gas bearing

8. ,

Hydrostatic gas bearing

9. - ,

Hydrodynamic bearing

10. - , -

Squeeze oil film bearing - -

11. - , \*
- Hydrostatic bearing .
- 12. - , -
- Hybrid bearing ,
- 13.
- Solid-film bearing
14. , \*
- Unlubricated bearing
15. - , «
- Self-lubricated bearing ( )
16. -
- Porous bearing
17. - , -
- Porous self-lubricating bearing
18. - , -
- Circular cylindrical bearing ( . 1)
19. , -
- Non-circular cylindrical bearing ( . 2)
20. , -
- Lobed bearing -
- , ( . 3)
21. , -
- Pad journal bearing ( . 4)
22. - , -
- Pad thrust bearing ( . 5)
23. ,
- Tilting bearing

. 1

24.	-	,	-
Tilting-pad journal bearing	( . 6 )	( )	-
25.		,	-
Tilting-pad thrust bearing	( . 7 )	,	-
26.		,	-
Floating bush bearing		,	-
27.		,	-
Multilayer bearing		( . 9 )	-
28.	-	,	-
Monometallic bearing	-	,	-
29.	-	,	-
Pedestal plain bearing		,	-
30.	-	,	-
Pedestal plain bearing		,	-
31.		,	-
Flanged plain bearing		,	-
32.	-	,	-
Plain half bearing		,	-
Half bearing		180°	-
33.	-	,	-
Thin walled half bearing		,	-

**35.**

## Bearing back

**Plain bearing bush**  
**Bearing bush**  
**Bush**

## Wrapped bearing bush

### Solid half bearing

**Multilayer bearing liner**  
**Multilayer liner**

## Flanged half bearing

## Bearing backing Backing

**Bearing anti-friction layer**  
**Anti-friction layer**  
**Lining**

**Bearing running-in layer**  
**Running-in layer**

44.		,	-
	Thrust washer	( . 10)	
45.	-	,	
	Thrust half-washer	( . 10)	
46.	-	,	-
	Pad	( . 6)	
47.		,	-
	Journal pad	( . 6)	-
48.		,	-
	Thrust pad	( . 5)	-
49.	-	,	
	Journal	( . 12)	
50.	-	,	-
		,	-
	Thrust collar pivot		
51.	-	,	-
	Oil ring	,	-
52.	-	,	-
	Plain bearing housing		
53.		,	-
	Plain bearing gasket		-
	Bearing gasket		
54.			
	Plain bearing housing cover plate		
	Cover plate		
55.	-		,
	Bearing flange		
56.	-		
		,	
	Earing bare	,	-
57.	-	,	-

<https://minable.ru/gosty>



, 1

72.	-	,	,	-
Locating fixture		(	. 20)	
73-	-		(	. 21)
Plain journal bearing inside diameter				
74.	(		)	-
Half bearing width		—		-
75.	-			-
Diametral plain journal bearing clearance				
Journal bearing clearance				
Clearance				
76.	-			-
Radial clearance of a circular cylindrical bearing			(	. 1)
77.	-			-
Radial clearance of a multi-shaped bearing		(	. 2)	-
78.	-			-
Relative clearance of a bearing				
79.				-
Half-bearing wall thickness			(	)
80.	-		(	. 21)
Bearing material layer thickness		,	,	-
			(	. 22)

81.	-	( . 5)	
Pad length			
82.			
Pad width		( . 23)	-
		—	-
	( . 4)		
83.			
Pad thickness	,	( . 23)	-
		—	
	( . 4)		
84.			-
Bore relief			
	( . 24)		
85.			-
Nip	,		-
Crush			-
		( .	
	25)		
86.	TM»	,	
Inclination		( . 26)	-
87.			
Free spread			
		( . 27)	
88.			-
Housing width			
89.			-
Housing length	,		-
90.			-
Housing height	,		-
91.	-		-
Housing face			
92.			-
Cooling fins	,		-
93.			-
Joint face			
94.	-		
Centre height of a pedestal plain bearing			

**<https://minable.ru/gosty>**

108.					-
Running-in ability					-
				,	-
					-
109.					-
Embeddability					-
110.					-
Wear resistance					-
				,	-
			—		-
				,	-
111.	-				-
Relative wear resistance					-
112.	-				-
					-
Temperature stability					

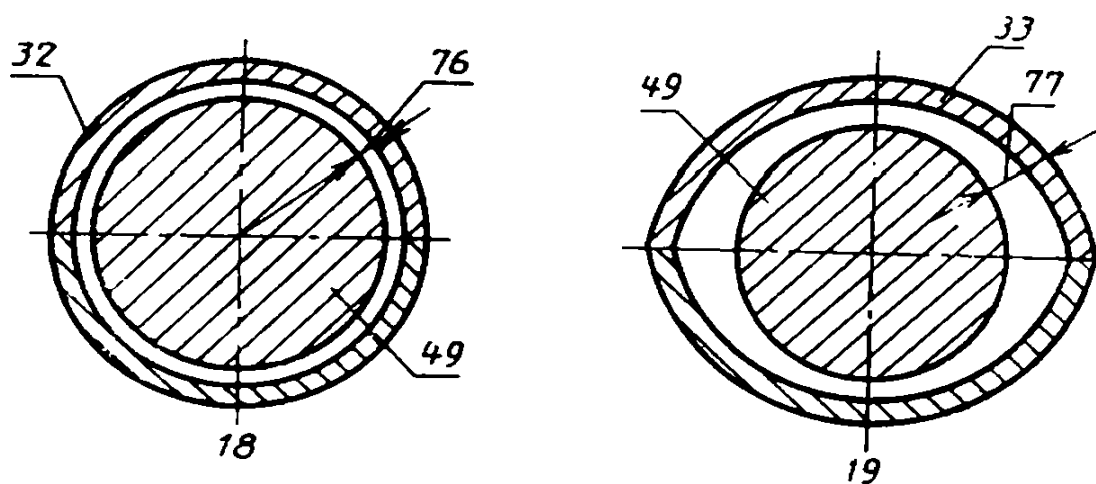

Черт. 2

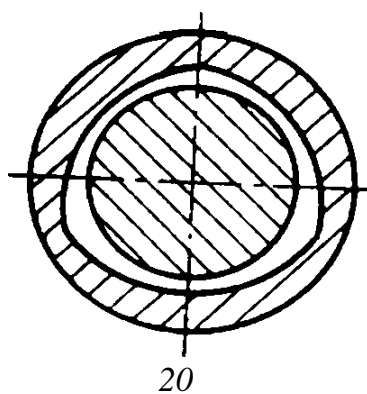

Черт. 3

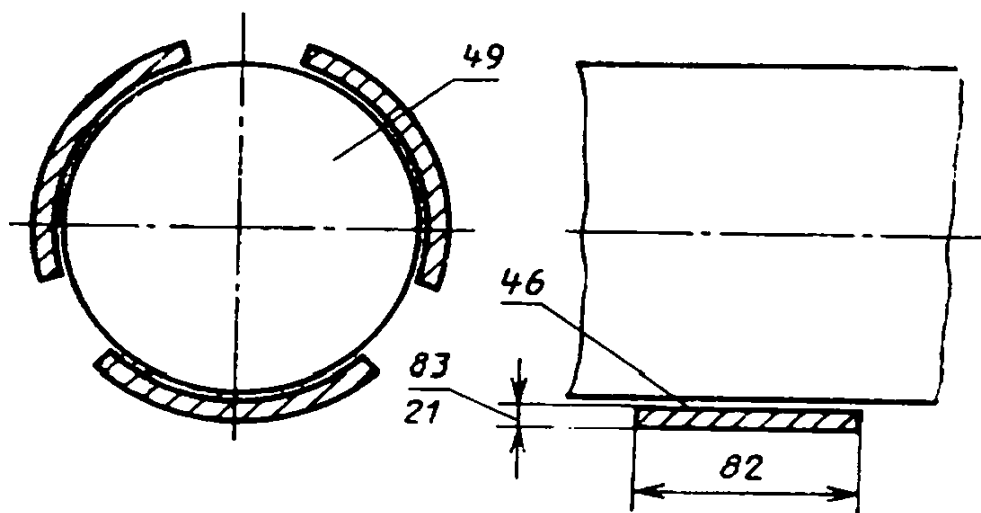

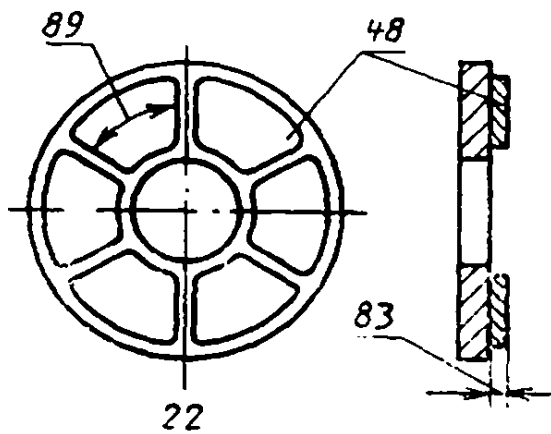

Черт. 5

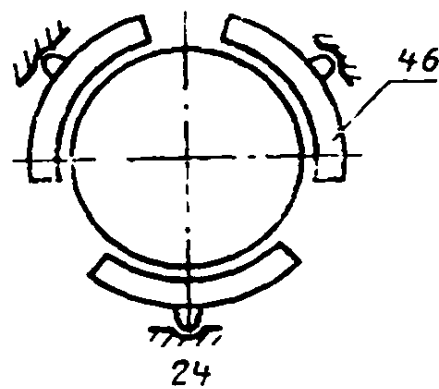

Черт. 6

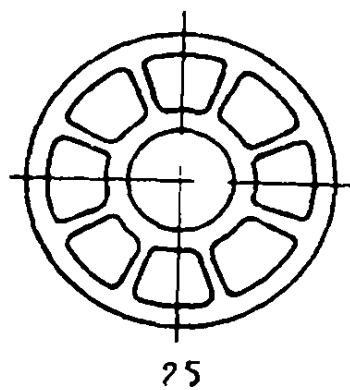

25

.7

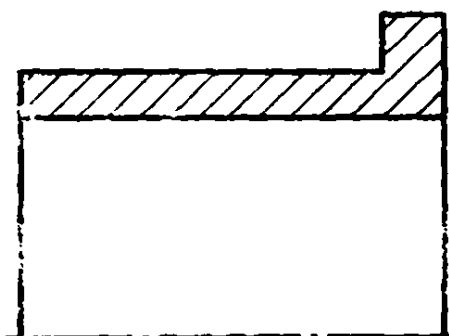

42

^77777/7777777^

.8

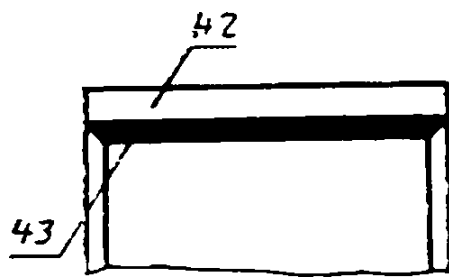

. 9

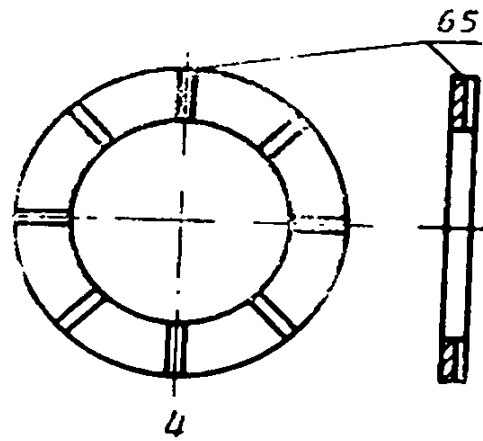

Черт. 10

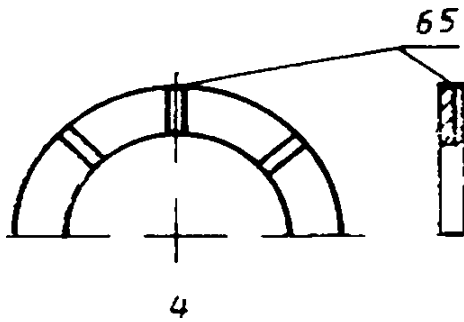

. 11

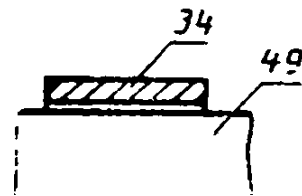

. 12

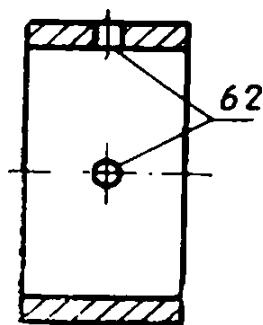

. 13

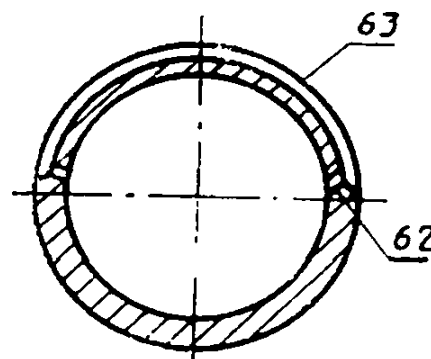

. 14

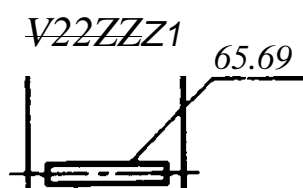

ZZZZZA

. 15

66

/

. 16

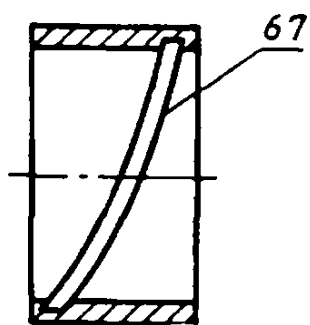

. 17

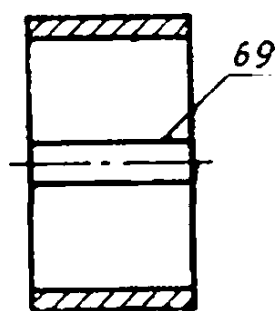

. 18

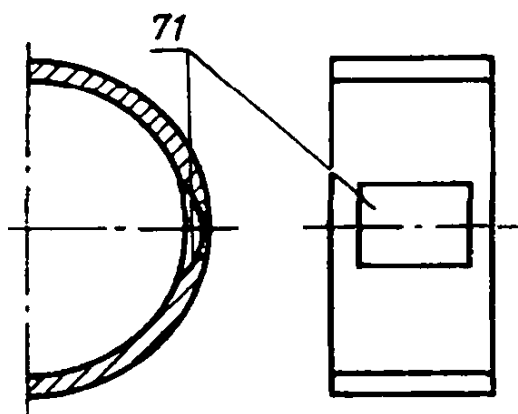

. 19

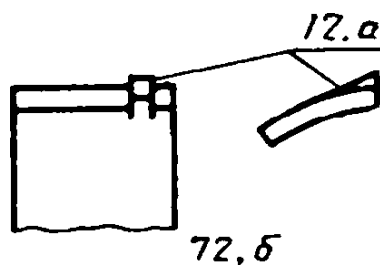

12.6

. 20



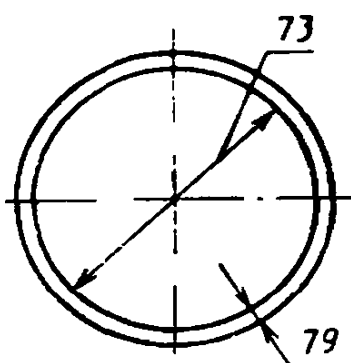

. 21

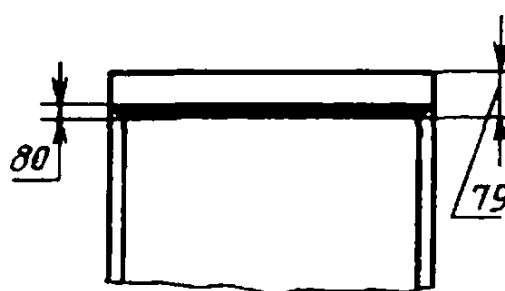

. 22

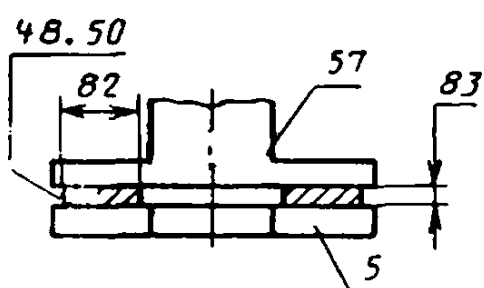

. 23



. 24

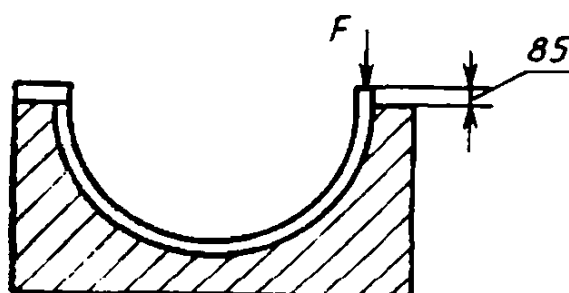

Черт. 25

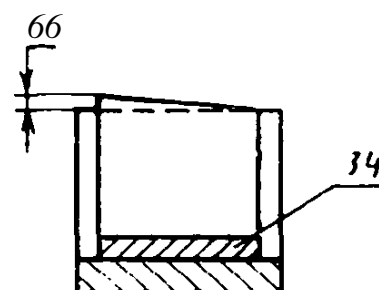

. 26

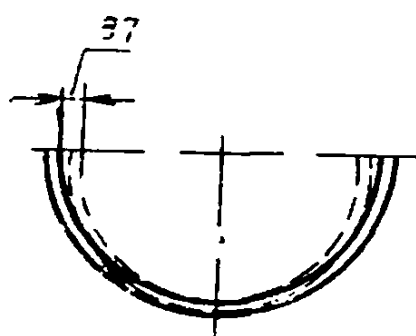

. 27

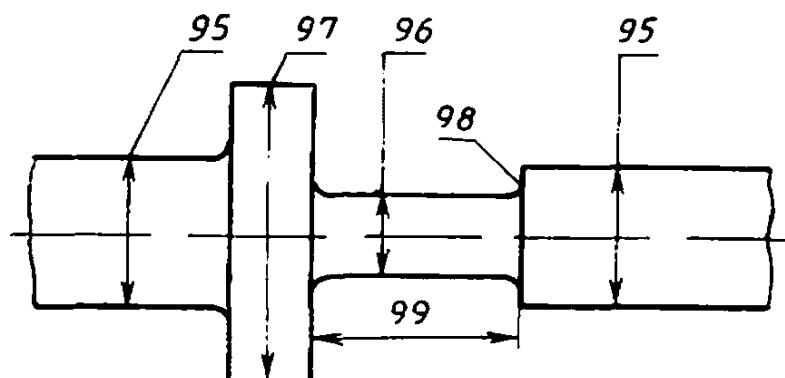

. 28

	32
	40
	39
	38
	34
	33
	36
	36
	40
	39
	38
	37
	90
	94
	5
	96
	73
	73
	97
	95
	88
	76
	77
	75
	75
	79
	98
	110
	111
	64
	64
	67
	69
	66
	70
	68
	65
	63
	63
	71
	71
	51
	51
	44
	44
	52
	52

. 2

90  
88  
89  
54  
100  
102  
103  
1Q1  
104  
104  
86  
59  
41  
41  
60  
62  
62  
58  
93  
  
56  
61  
35  
91  
46  
46  
47  
48  
10  
1  
7  
8  
9  
11  
12  
3  
29  
30  
31  
18  
20  
27  
28  
19  
14  
26  
16  
4  
6  
17  
15  
23

24  
25  
21  
22  
13  
2  
5  
45  
45  
107  
107  
108  
50  
50  
81  
87  
99  
92  
37  
84  
42  
43  
42  
106  
109  
105  
105  
112  
112  
83  
80  
79  
63  
65  
72  
49  
49  
74  
74  
89  
82  
57  
72

<b>Adhesion ability</b>	<b>105</b>
<b>Anti-friction layer</b>	<b>42</b>
<b>Anti-friction material</b>	<b>100</b>
<b>Backing</b>	<b>41</b>
<b>Backing material</b>	<b>102</b>
<b>Bearing anti-friction layer</b>	<b>42</b>
<b>Bearing back</b>	<b>«35</b>
<b>Bearing backing</b>	<b>41</b>
<b>Bearing base</b>	<b>56</b>
<b>Bearing bush</b>	<b>36</b>
<b>Bearing flange</b>	<b>55</b>
<b>Bearing gasket</b>	<b>53</b>
<b>Bearing insulation</b>	<b>57</b>
<b>Bearing material</b>	<b>100</b>
<b>Bearing material layer thickness</b>	<b>80</b>
<b>Bearing running-in layer</b>	<b>43</b>
<b>Bore relief</b>	<b>84</b>
<b>Bush</b>	<b>36</b>
<b>Centre height of a pedestal plain bearing</b>	<b>94</b>
<b>Circular cylindrical bearing</b>	<b>18</b>
<b>Circumferential groove</b>	<b>66</b>
<b>Clearance</b>	<b>75</b>
<b>Collar diameter</b>	<b>97</b>
<b>Compound material</b>	<b>103</b>
<b>Conformability</b>	<b>107</b>
<b>Cooling fins</b>	<b>92</b>
<b>Cover plate</b>	<b>54</b>
<b>Crush</b>	<b>85</b>
<b>Diametral plain journal bearing clearance</b>	<b>75</b>
<b>Distance between shoulders</b>	<b>99</b>
<b>Dynamically loaded plain bearing</b>	<b>3</b>
<b>Embeddability</b>	<b>109</b>
<b>Flanged half bearing</b>	<b>40</b>
<b>Flanged plain bearing</b>	<b>31</b>
<b>Floating bush bearing</b>	<b>26</b>
<b>Free spread</b>	<b>87</b>
<b>Friction compatibility</b>	<b>106</b>
<b>Gutterway</b>	<b>70</b>
<b>Half bearing</b>	<b>32</b>
<b>Half bearing wall thickness</b>	<b>79</b>
<b>Half bearing width</b>	<b>74</b>
<b>Helical groove</b>	<b>67</b>
<b>Housing face</b>	<b>91</b>
<b>Housing height</b>	<b>90</b>
<b>Housing length</b>	<b>89</b>
<b>Housing width</b>	<b>88</b>
<b>Hybrid bearing</b>	<b>12</b>
<b>Hydrodynamic bearing</b>	<b>9</b>
<b>Hydrodynamic gas bearing</b>	<b>7</b>

Hydrostatic bearing	11
Hydrostatic gas bearing	3
Inclination	86
Joint face	93
Journal	49
Journal bearing	4
Journal bearing clearance	75
Journal diameter	95
Journal pad	47
Lining	42
Lobed bearing	20
Locating fixture	72
Longitudinal groove	65
Monometallic bearing	88
Multilayer bearing	27
Multilayer bearing liner	39
Multilayer bearing material	101
Multilayer liner	39
Nip	85
Non-circular cylindrical bearing	19
Oil discharge opening	60
Oil feed opening	59
Oil groove	64
Oil hole	62
Oil outer groove	63
Oil pocket	71
Oil ring	51
Oil ring slot	58
Open groove	68
Pad	46
Pad journal bearing	21
Pad length	81
Pad thickness	83
Pad thrust bearing	22
Pad width	82
Pedestal plain bearing	29. 30
Plain bearing	1
Plain bearing bush	36
Plain bearing gasket	
Plain bearing housing	52
Plain bearing housing bore	61
Plain bearing housing cover plate	54
Plain half bearing	36
Plain journal bearing	4
Plain journal bearing inside diameter	73
Plain thrust bearing	5
Porous bearing	16
Porous self-lubricating bearing	17
Radial clearance of a circular cylindrical bearing	76
Radial clearance of a multishaped bearing	77
Relative clearance of a bearing	78
Relative wear resistance	111

<b>Running-in ability</b>	<b>108</b>
<b>Running-in layer</b>	<b>43</b>
<b>Self-lubricated bearing</b>	<b>15</b>
<b>Shaft diameter</b>	<b>96</b>
<b>Shoulder of the shaft</b>	<b>98</b>
<b>Sintered bearing material</b>	<b>104</b>
<b>Sintered material</b>	<b>104</b>
<b>Solid-film bearing</b>	<b>13</b>
<b>Solid half bearing</b>	<b>38</b>
<b>Squeeze oil bearing</b>	<b>10</b>
<b>Steadily loaded bearing</b>	<b>2</b>
<b>Stopped off groove</b>	<b>69</b>
<b>Temperature stability</b>	<b>112</b>
<b>Thick walled half bearing</b>	<b>34</b>
<b>Thin walled half bearing</b>	<b>33</b>
<b>Thrust bearing</b>	<b>5</b>
<b>Thrust collar diameter</b>	<b>97</b>
<b>Thrust collar pivot</b>	<b>50</b>
<b>Thrust half-washer</b>	<b>45</b>
<b>Thrust journal bearing</b>	<b>6</b>
<b>Thrust pad</b>	<b>48</b>
<b>Thrust washer</b>	<b>44</b>
<b>Tilting bearing</b>	<b>23</b>
<b>Tilting-pad journal bearing</b>	<b>24</b>
<b>Tilting-pad thrust bearing</b>	<b>25</b>
<b>Unlubricated bearing</b>	<b>14</b>
<b>Wear resistance</b>	
<b>Wrapped bearing bush</b>	<b>37</b>

1.

· · · · · , - , ; · · · · · , - ,  
 ; · · · · · , - , ; · · · · · , - ,  
 ; 3. · · · · · ; · · · · · , - , ;  
 · · · · · , · · · · · ; · · · · ·

2.

494

-  
09.03.88

3.

18282—72.

4.

4378/1.

5.

-

-

,

23.002—78

A. Af.

· 19 000 · 29.03 63 , · 09 06.88 1,5 · · · 1,63 · - · 1,60 10 · ·  
 « · « » , 123840. · · · · · 6. · 2148 · - · · 3  
 · « · ».