

■



2010

8951-75

Ductile iron fittings with
parallel thread for pipelines.
Straight four-way junction pieces. Basic dimensions

8951-59

23.040.60

14.11.75

2901

01.01.77

2—92

(2—93)

1.

3301—81.

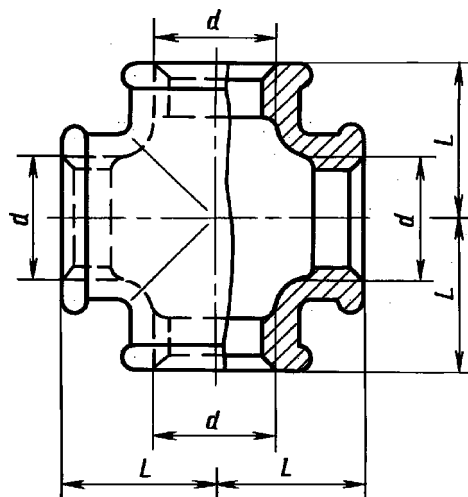

(2010 .)

1, 2,
(11-80, 7-83).

1980 .

1983 .

©

©

, 1975
, 2010

D_y	d	L	*	
			8944-75	
			1	2
8	G V ₄ —	21	0,083	0,089
10	G 3/8 —	25	0,105	0,113
15	G 2 -	28	0,163	0,179
20	G V ₄ -	33	0,284	0,254
25	G 1 -	38	0,383	0,392
32	G 1 7/8 -	45	0,585	0,561
40	G 1 7/2 -	50	0,797	0,681
50	G 2 -	58	1,251	1,117
(65)	G 2 2 -	69	1,769	1,587
(80)	G 3 -	78	2,351	2,119
(100)	G 4 -	96	4,585	3,921

*

1. D_y
 2.
 5 %.

. 25 :

25 8951-75

, :

-25 8951-75

(, . 1,2).

2. — 8944—75.