

■



2010

8953-75

Ductile iron fittings with
parallel thread for pipehnes.
Four-way junction pieces with two passages. Basic dimensions.

8953-59

MKC 23.040.60

14.11.75

2901

01.01.77

2—92

(2—93)

1.

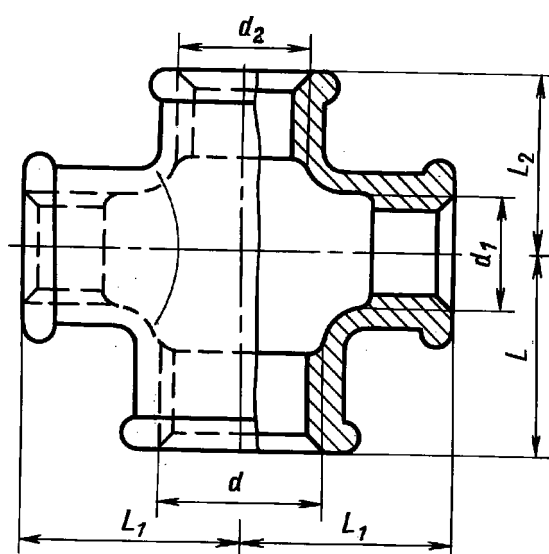

(2010 .)

1,

1980 . (11—80).

©

©

, 1975
, 2010

. 2 8953-75

<div><div><div>D_y</div><div>D_y</div><div>D_{v2}</div></div></div>				L	L_I	$\wedge 2$	* , ,	
	d	d_2	d_2				8944-75	
							1	2
20x15x15	G $\frac{3}{4}$ -	G V_2 -	G V_2 -	30	31	28	0,200	0,180
20 x20x15	G V_4 -	G V_4 -	G V_2 -	33	33	31	0,264	0,217
25x15x20	G 1 -	G V_2 -	G $\frac{3}{4}$ -	32	34	30	0,252	0,230
25x20x20	G 1 -	G V_4 -	G V_4 -	35	36	33	0,316	0,268
32x20x25	G 1 $\frac{1}{4}$ -	G $\frac{3}{4}$ -	G 1 -	36	41	35	0,396	0,342

*

5 %.

$D_y 25$ $Z_{yi} 15$ $2 20$:
25 15 20 8953-75

-25 15 20 8953-75

(
2. , . 1).

— 8944—75.